

AP6: West of Adanac Drive

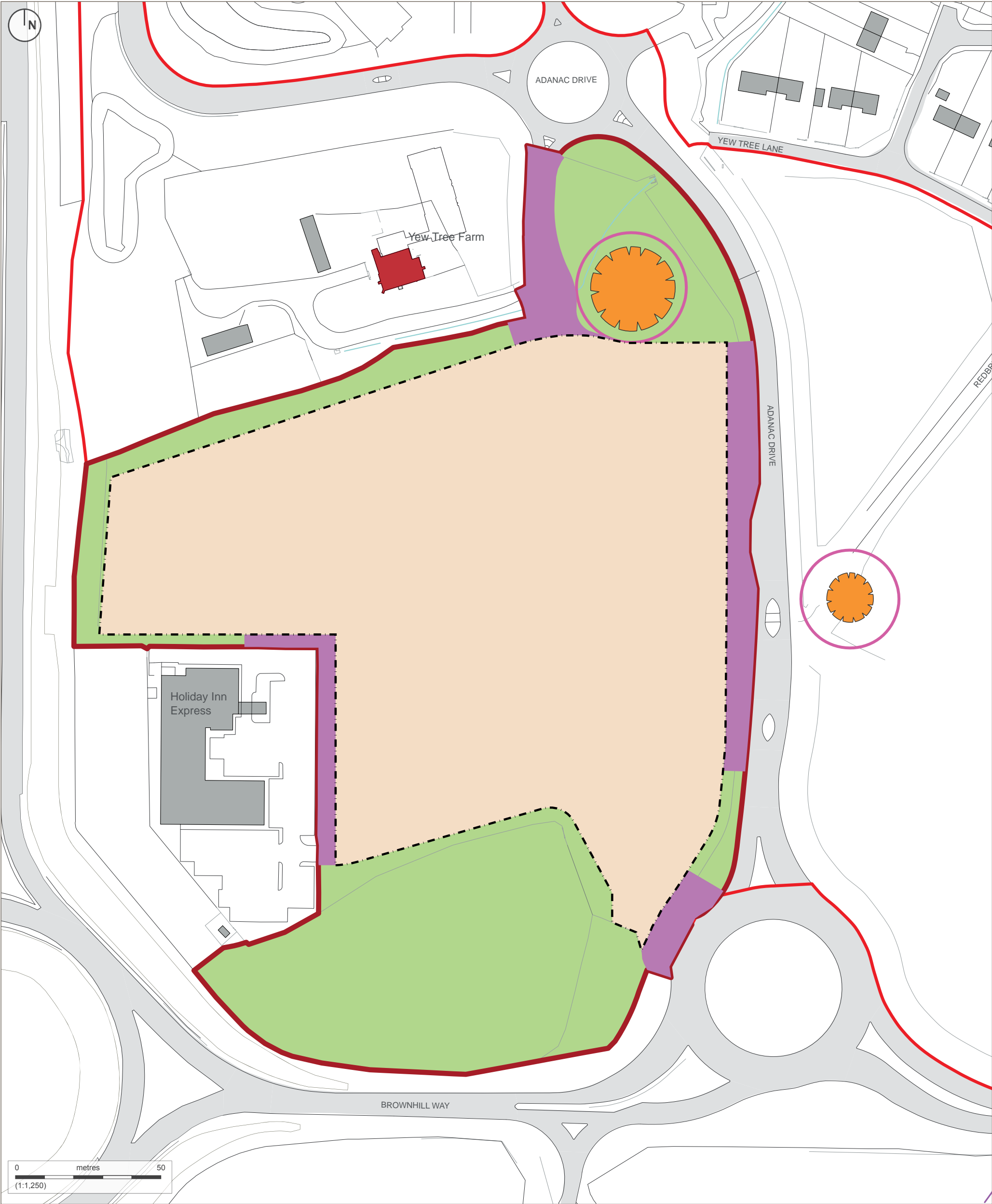

Plans reproduced by permission of Ordnance Survey on behalf of The Controller of Her Majesty's Stationery Office. © Crown Copyright and database right [2014]. All rights reserved. Ordnance Survey Licence number [100020449].

Copyright of Turley.

This drawing is for illustrative purposes only and should not be used for any construction or estimation purposes.

DO NOT SCALE DRAWINGS.

No liability or responsibility is accepted arising from reliance upon the information contained within this drawing.

- Adanac Park development framework area
- Development parcel
- Development zone boundary
- Strategic planting

- Retained TPO tree and root protection zone
- Access zone (zone in which access will be taken through the strategic planting)
- Listed building

Client:
Trustees of the Barker Mill Estates

Project:
Adanac Park

Drawing:
Parcel Parameter Plan

Drawing Number:
AP6-P-5

Project Number:
TRUW2038

Date:
September 2014

Revision:
2.0

Status:
Final

Scale:
1:1,250 @ A3

Turley